



Acme Sanitary Ware Co Ltd











Acme Building, 22-28 Nanking Street, Kowloon, Hong Kong
 Tel: 2388 7171 Fax: 2710 8012
 E-mail: acme@acmesanitary.com.hk
 Website: www.acmesanitaryware.com.hk

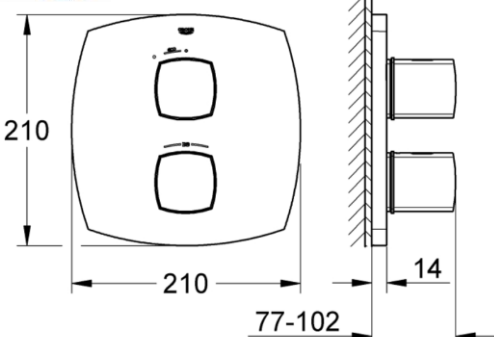
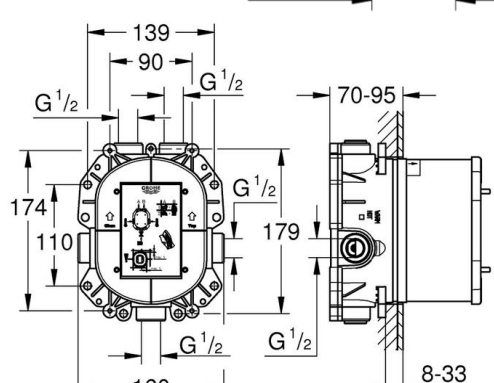

Pure Freude
an Wasser

PROJECT		REF		REV	ITEM CODE	
LOCATION		DATE			PAGE	

SANITARY WARE SPECIFICATION SHEET

Item Descriptions	GROHE (Germany) "Grandera" Thermostatic shower mixer trim with concealed body	Illustration/ Drawing
Dimensions	L210 x W102 x H210 mm	   
Model	19934IG0 (Thermostatic mixer) 35500000 (Mounting box)	
Finish	Chrome Plated & Gold	
Country of origin	Germany	
Manufacturer	GROHE Limited	
Supplier	Acme Sanitary Ware Co. Ltd Mr. Eric Wong/ Mr. Don Yuen	
Contact Tel/Fax	(852) 2388-7171 / (852) 2710-8012	
E-mail	acme@acmesanitary.com.hk	     
Website	www.acmesanitary.com.hk	
"Grandera" Thermostatic shower mixer	<ul style="list-style-type: none"> set for final installation for GROHE Rapido T 35 500 000 / 35 050 000 without concealed body TMV2 compliant when used with 35 050 000 GROHE StarLight chrome finish GROHE SafeStop safety button at 38°C (calibration required) GROHE SafeStop Plus optional temperature limiter at 43°C included volume handle with GROHE EcoButton (economy button with individually adjustable economy stop) ceramic headparts 1/2", 180° wall escutcheon with GROHE QuickFix (covered escutcheon- and shaft sealing, covered fixing) metal handles 	
"GROHE Rapido T" Thermostatic mixer for concealed installation	<ul style="list-style-type: none"> for use with Grohtherm Special without finishing trim set flat installation depth 70 - 95 mm easy to install, premounted and tested unit GROHE TurboStat compact cartridge with wax thermoelement two top outlets 1/2", lockable high flow rate up to 50 l/min. by use of three outlets bottom outlet 1/2" can be used only with separate stop valve safe to install, stable built-in-box and protective cap fixation options for solid walls and dry cladding material for wall sealing included Aquadimmer-diverter for bath mixer or stop valve for shower mixer in finishing trim set body of DR brass built-in non return valves and dirt strainers GROHE EcoJoy technology for less water and perfect flow min. recommended pressure 1.0 bar 	

Note:  <https://www.youtube.com/watch?v=M5vlCM45qkE>

* All information of the above is for the reference only. No prior notice is made if any changes.



Acme Sanitary Ware Co Ltd

Acme Building, 22-28 Nanking Street, Kowloon, Hong Kong
Tel: 2388 7171 Fax: 2710 8012
E-mail: acme@acmesanitaryware.com.hk
Website: www.acmesanitaryware.com.hk



Pure Freude
an Wasser

PROJECT		REF		REV	ITEM CODE	
LOCATION		DATE			PAGE	

SANITARY WARE SPECIFICATION SHEET

GROHE GRANDERA

TOMORROW'S GRAND STYLE

The GROHE Grandera collection is both a homage to an age of grandeur long past and an affirmation of modern sensibility, combining the highest standards of quality and craftsmanship with a love of detail and comfort.

Stylistically, the Grandera collection can be combined with a wide range of bathroom furnishings, with the added flexibility of two colors – chrome and chrome / gold.



GROHE StarLight®

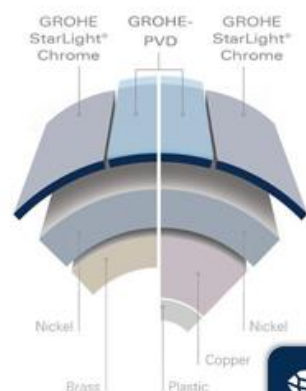

GROHE surface
hardness



Chrome PVD

GROHE scratch
resistance



Chrome PVD



GROHE SafeStop (Plus) – double scalding protection at 38°C and (optional) 43°C

Great for homes with children, this safety feature is set at 38°C, preventing you from turning up the water temperature too high. If desired, higher temperatures can be selected by pushing the button. Optional for extra safety: the easy-to-fit GROHE SafeStop Plus limiter ensures that the temperature does not exceed 43°C.



GROHE EcoButton – reduce your water consumption by up to 50% at the push of a button

Using this button you can select either a full water flow, e.g. for quick tub filling, or reduce your water consumption by up to 50% – without compromising on your comfort!



GROHE QuickFix Plus quick and easy installation in a few simple steps

Save time on the installation of your tap with GROHE QuickFix Plus. Consisting of fewer parts, our new system makes the installation process quicker and easier than ever.



Constant water temperature thanks to reliable GROHE TurboStat technology

Our precise control technology ensures an instant water flow at the desired temperature and keeps it constant irrespective of any fluctuations in water pressure or supply.



GROHE EcoJoy with water-saving function for reduced consumption

GROHE EcoJoy reduces water consumption by up to 50% without compromising on performance. Whenever you turn on your tap, you will enjoy a full jet of water while saving money nonetheless.

Note:

* All information of the above is for the reference only. No prior notice is made if any changes.



Acme Sanitary Ware Co Ltd

Acme Building, 22-28 Nanking Street, Kowloon, Hong Kong
Tel: 2388 7171 Fax: 2710 8012
E-mail: acme@acmesanitary.com.hk
Website: www.acmesanitaryware.com.hk



Pure Freude
an Wasser

PROJECT		REF		REV	ITEM CODE	
LOCATION		DATE			PAGE	

SANITARY WARE SPECIFICATION SHEET

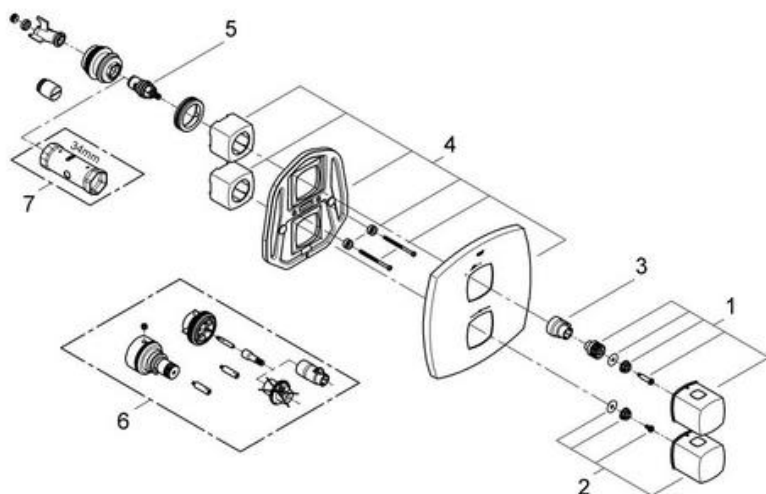

Pos.-nr.	Prod. description	Order-nr.
2	Temperature control handle	47934000
3	Stop	10093000
4	Escutcheon	47935000
5	Ceramic headpart, 1/2"	45346000
5.1	O-ring Ø 18.2 x Ø 1.7	0392400M
6	Extension-set 27.5 mm	47780000*
7	Socket spanner	19332000*

* Optional accessories

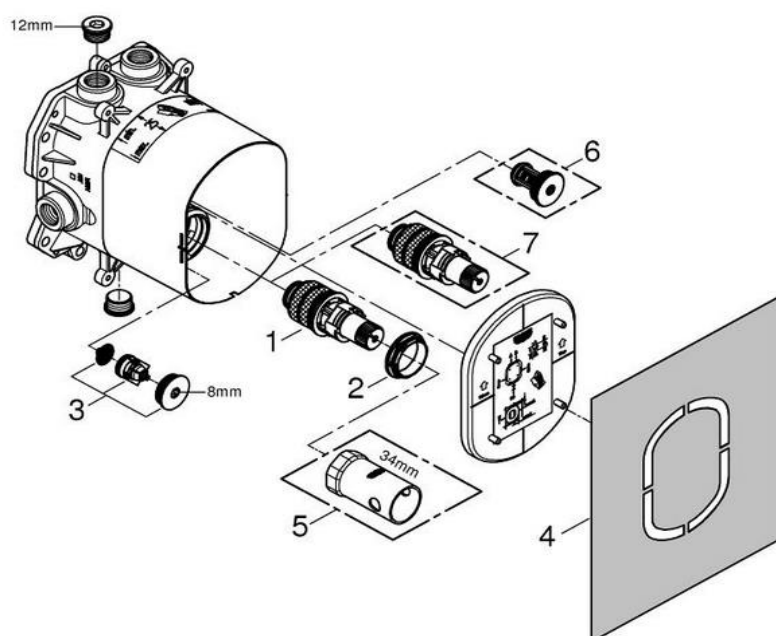

Pos.-nr.	Prod. Description	Order-nr.
1	Thermostatic compact cartridge 3/4"	47483000
2	Fitting ring	47765000
3	Non-return valve	47753000
4	Repl. kit f. seal	48263000
5	Socket spanner	19332000*
6	Safety combination (DIN EN 1717)	29007000*
7	Thermostatic compact cartridge 3/4"	47186000*

* Optional accessories

Note:

* All information of the above is for the reference only. No prior notice is made if any changes.